

014-122-002-000  
Lot 06, Block 08, Tract 573  
16,948 sq ft

1399 Roosevelt Ave  
Salton City, CA

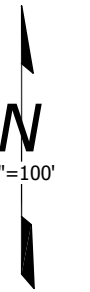

Bk 7  
Pg 11

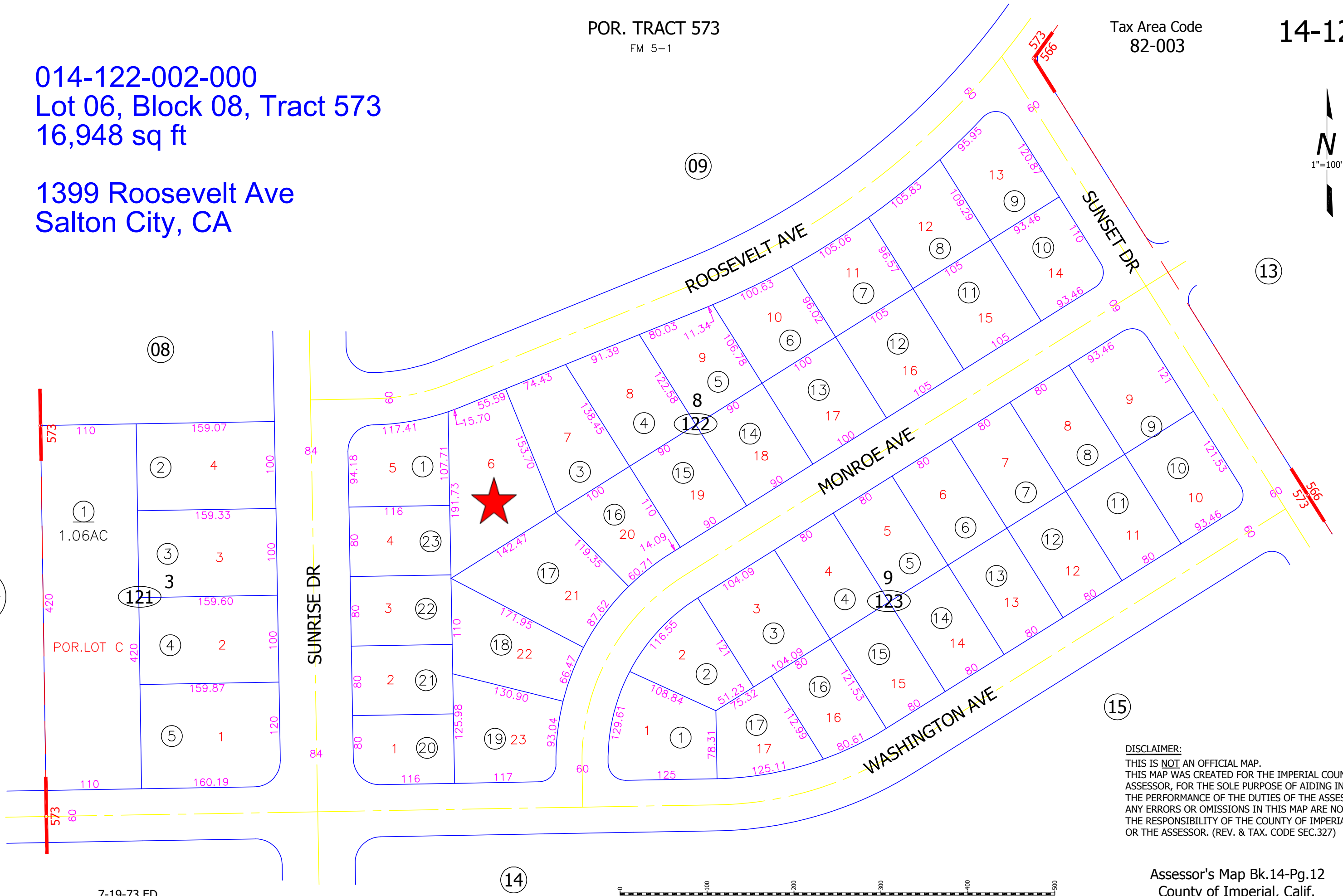

**DISCLAIMER:**  
THIS IS NOT AN OFFICIAL MAP.  
THIS MAP WAS CREATED FOR THE IMPERIAL COUNTY ASSESSOR, FOR THE SOLE PURPOSE OF AIDING IN THE PERFORMANCE OF THE DUTIES OF THE ASSESSOR. ANY ERRORS OR OMISSIONS IN THIS MAP ARE NOT THE RESPONSIBILITY OF THE COUNTY OF IMPERIAL OR THE ASSESSOR. (REV. & TAX. CODE SEC.327)

